

BROODTM

DRNX BRW BY BROOD
MANUAL

| | |
|---------------------|----|
| SAFETY REGULATIONS | 3 |
| GENERAL INFORMATION | 4 |
| COMPONENTS | 5 |
| INSTALLATION | 6 |
| OPERATION | 7 |
| ADJUSTABLE SETTINGS | 8 |
| CARE | 9 |
| TROUBLESHOOTING | 10 |
| FAQ | 11 |
| WARRANTY | 12 |
| DECOMMISSIONING | 13 |
| CONTACT | 14 |

NEVER ALLOW WATER TO COME INTO CONTACT WITH ANY OF THE ELECTRICAL PARTS OF DRNX BRW: THERE IS A DANGER OF CREATING A SHORT CIRCUIT.

INTENDED USE

DRNX BRW is intended to be used in cafes, restaurants, and pantries. It dispenses liquid from its internal reservoir, infusing it with atmospheric nitrogen and chilling it to 2°C. Do not pour liquids that are above room temperature or that are unfiltered. It must only be operated by a trained person. The appliance is not to be used by persons (including children) with reduced physical, mental or sensory abilities or with scarce experience and/or expertise, unless they are supervised by a person responsible for their safety, or they are instructed by this person on how to properly use DRNX BRW.

POWER SUPPLY

DRNX BRW must be connected to the power supply in accordance with its specifications. Only connect it with the specified supply voltage.

POWER CORD

Never use DRNX BRW if the power cord is defective. Report any defects in the cord and/or plug to the service provider immediately. Do not pass the power cord around corners, over sharp edges or over hot objects and keep it away from oil. Do not use the power cord to carry or pull the machine. Do not pull out the plug by the power cord nor touch it with wet hands. Do not let the power cord hang freely from tables or shelves.

FOR THE SAFETY OF OTHERS

Ensure that children cannot play with DRNX BRW and/or the packaging materials. Observe the warning and safety instructions on the electrical components and in this manual. Improper use of DRNX BRW such as opening it during operation, incorrectly operating it, or not following standard guidelines for operating electrical equipment may lead to injury.

FIRE SAFETY PRECAUTIONS

In case of fire, use carbon dioxide (CO₂) extinguishers. Do not use water or dry powder extinguishers.

SUITABLE LOCATION FOR OPERATION AND MAINTENANCE

DRNX BRW should be installed in accordance with the safety regulations in force at the time of installation. Operate it in an environment between 13°C and 32°C. Make sure it is a dust-free environment. Avoid placing open flames and/or incandescent objects near it to avoid melting or other damage to the dispenser housing. If the dispenser has been exposed to such conditions, alert the service provider who will carry out a safety check.

STORING DRNX

If DRNX BRW is to remain inactive for a long time, turn it off and unplug it. Store it in a dry place, out of reach of children. Make sure the storage area is between 13°C and 40°C. Keep it protected from dust and dirt.

SAFETY REGULATIONS

GENERAL INFORMATION

REPAIRS / MAINTENANCE

In case of failure, problems or a suspected fault resulting from a fall, immediately remove the plug from the power socket and alert the service provider or specialized technician. Never attempt to operate it if it is faulty. Please report any fault to your service provider. Only the service provider and/or technician may carry out servicing operations and repairs on DRNX BRW, unless otherwise informed. Any repair of the dispenser must be done only when it is switched off and it is ascertained that there is no electric current. All spare parts must be obtained from your service provider. Follow the service and maintenance instructions in this operation manual.

USE

DRNX BRW pulls any filtered liquid from an internal reservoir. The liquid can be poured directly into the reservoir, or it can be housed in a soft-walled Bag-in-Box (BiB) bladder. The reservoir is refrigerated such that the liquid is dispensed at 2°C. It can be infused with atmospheric nitrogen, or it can be poured still.

VISCOSITY OF LIQUID

Ensure that your beverage has been filtered. Thick liquids risk slowing down the liquid pump inside. DRNX BRW comes with a pre-filter that is already fitted into the machine.

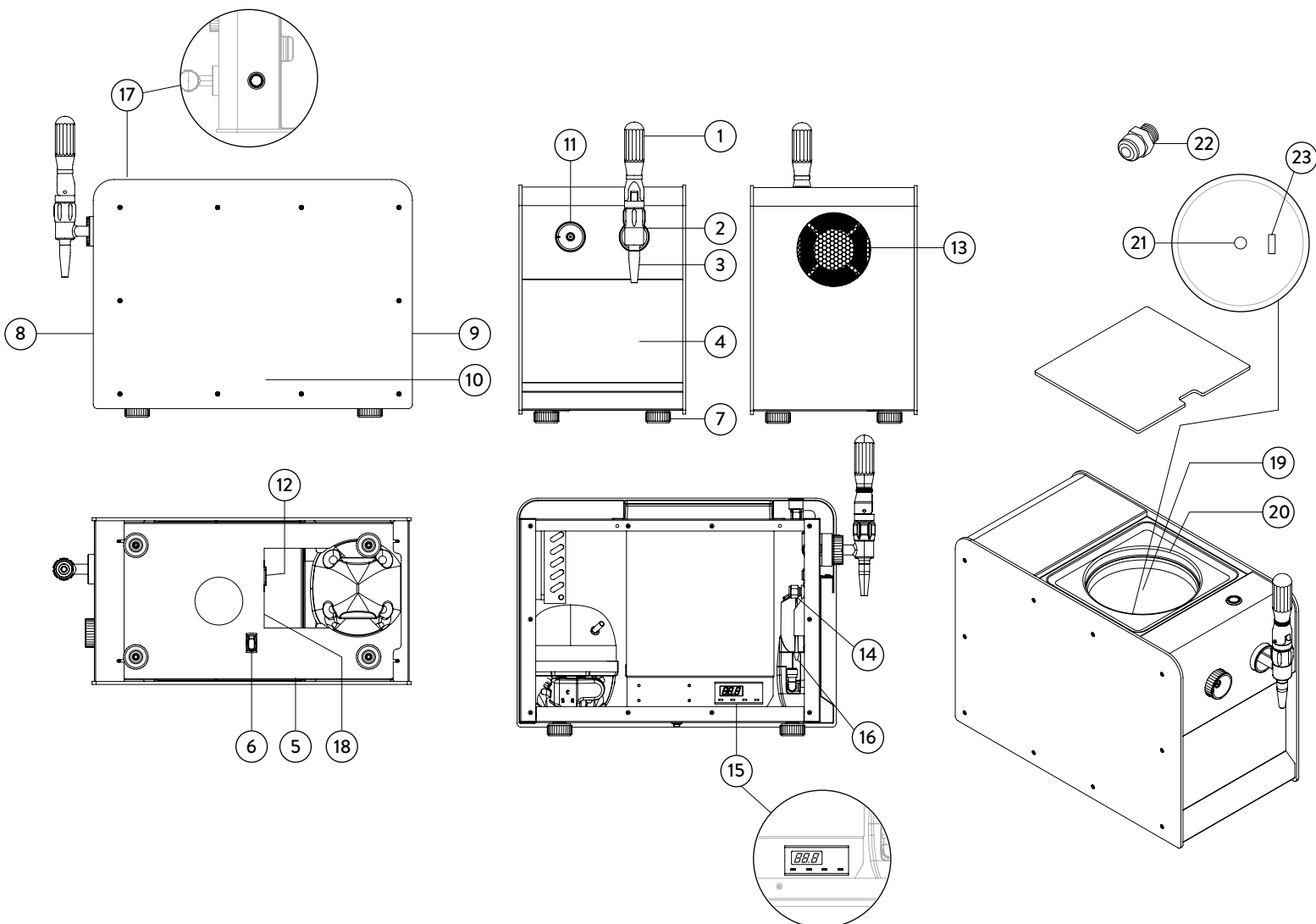

- 1 – Tap Handle
- 2 – Tap Body
- 3 – Nozzle
- 4 – Exterior
- 5 – Inlet Connector
- 6 – Main ON/OFF Switch
- 7 – Legs
- 8 – Forward Plate
- 9 – Rear Plate

- 10 – Side Panel(s)
- 11 – Infuser Dial
- 12 – Power Plug
- 13 – Vents/Exhaust
- 14 – Pre-Filter
- 15 – Thermostat
- 16 – Calibration Knob
- 17 – Pump ON/OFF Switch
- 18 – Ventilation Valve

- 19 – Internal Reservoir
- 20 – Internal Reservoir Collar
- 21 – Magnetic Stir Bar
- 22 – BiB bladder Adapter
- 23 – BiB bladder Adapter Inlet

SPECIFICATIONS

| | |
|--|--|
| Width: 10.25in | Power Supply: 100-120V/60Hz; 200-240V/50Hz |
| Height: 14.75in | Nominal Power: 334W |
| Depth: 20.00in | |
| Weight: 73lbs | |
| Dispensing Capacity: 1.5L/min (0.4gpm) | |
| Coffee Temp at Tap: 2°C (36°F) | |

SETUP

1. Install on a clean and dry surface.

Allow no less than 20 centimetres of space from the back.

2. Assemble the tap handle.

Tilt the machine slightly if you need to.

3. For use with a BiB bladder, screw the BiB bladder adapter into the BiB bladder inlet.

Place your BiB bladder adapter towards the bottom of the reservoir. This will allow the contents of the BiB bladder to flow through the machine with ease. Never use a BiB bladder that has a stiff wall.

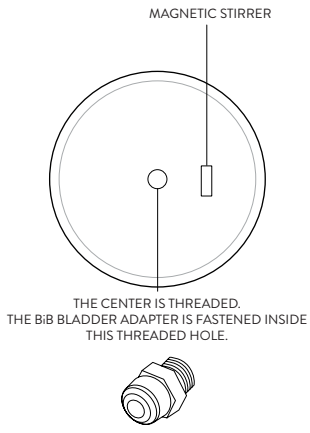

STEPS

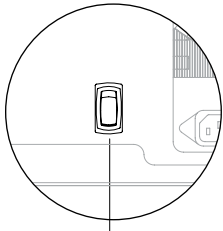

MAIN ON/OFF SWITCH
ON BOTTOM OF MACHINE

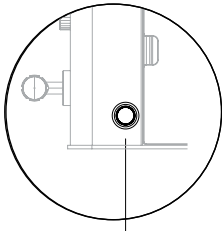

PUMP ON/OFF SWITCH
ON TOP OF MACHINE

1. Switch on the main ON/OFF button at the bottom of the machine. There will be a red light when the switch is on.
2. Switch on the pump ON/OFF button located at the top of the machine.



There will be a red light when the switch is on.

Pour the beverage into the reservoir and pull the tap forward to prime the pump.

The pump will automatically turn off if it runs dry for one minute.

This will notify the operator that the beverage container is empty.

Simply switch the pump off, then on again to reset.

3. Place the magnetic stir bar at the bottom of the internal reservoir.
4. Pour your beverage into the internal reservoir. Make sure not to pour above the internal reservoir collar. Make sure not to dislodge the magnetic stirrer when pouring.
5. Place your cup beneath the stout at an angle. To pour a STILL beverage, turn the infuser dial counter-clockwise. To pour a NITRO beverage, turn the infuser dial clockwise.

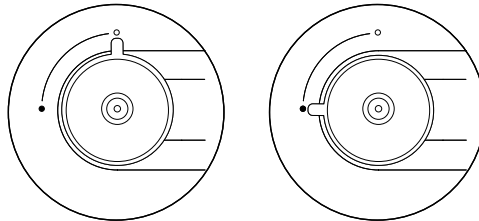

Please note, if the last pour was nitro cold brew and the operator wants the next pour to be still cold brew, there will be less than 10 mL (0.34 oz) of nitro cold brew in the tap that will come out. Every subsequent still cold brew pour will come out fully still, until the next nitro cold brew pour.

6. Return the tap to the start position when you have completed the pour.



Ensure that the coffee is filtered with a fineness of at least 100 μm (microns).



WARNING: Never run hot liquid above 30°C (86°F) through DRNX BRW.

TEMPERATURE CONTROL

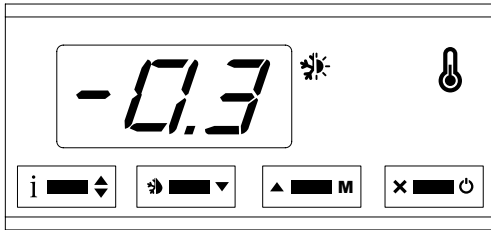

i [button icon] Info / Setpoint button.

↵ [button icon] Manual defrost / Decrease button.

▲ [button icon] Increase / Manual Activation button.

x [button icon] Exit / Stand-by button.

MODIFICATION OF DESIRED TEMPERATURE VALUE

Press button **i** [button icon] for at least half second, to display the setpoint value.

By keeping button **i** [button icon] pressed, use button **▲** or **▼** to set the desired value.

When button **i** [button icon] is released, the new value is stored.

If the operator sets the temperature at freezing, it runs the risk of freezing the Cold Brew. If this happens, turn off the fridge as described in step 2. Keep off for 2 hours.

NITROGEN CALIBRATION

Locate the infuser dial at the front of the machine. Turn the dial counter-clockwise towards the 9 o'clock position to pour a still drink. Turn the dial clockwise towards the 12 o'clock position to pour a nitrogenated drink.

If the level of nitrogen infusion is too high at the maximum (12 o'clock) position, then follow the steps below to decrease the level of nitrogen infusion. This is a one-time calibration process to adjust the amount of infusion at the maximum position only.

1. Locate and remove the ten screws on the left panel.
2. Locate the calibration knob at the forefront section. Turning it clockwise will decrease the amount of nitro.
3. Return the side panel and screw it securely.

CLEAN & MAINTAIN

 Follow the cleaning procedures below as it is essential to both extend the life of the DRNX BRW, and to achieve the desired flavor of cold brew. It must be cleaned twice week as described in the steps below.

 Never use hot water during the cleaning procedure.

BI-WEEKLY CLEANSE

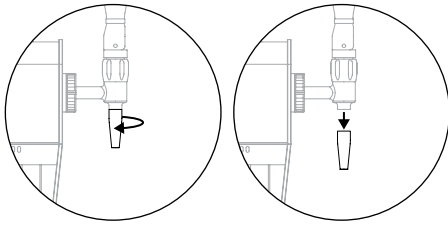

1. **Empty the reservoir by pouring out all liquid through the tap.**
If using a BiB bladder, then unscrew the BiB bladder adapter and remove both the adapter and the bladder from the reservoir.
2. **Remove the magnetic stir bar and put in a bath of cleaning detergent.**
3. **Fill the reservoir with room temperature water.**
4. **Prepare the cleaning solution.**
Dissolve any espresso cleaning detergent in the water to create a cleaning solution.
5. **Unscrew the nozzle from the tap by turning it counter-clockwise. Wash the nozzle with clean water.**
After washing, please reassemble it onto the tap.
6. **Connect a 1/4 inch tube to the ventilation port.**
Drop the other end of the tube into the cleaning solution inside the reservoir.
7. **After 30 minutes have passed pull the tap downward to run the solution through DRNX BRW.**
Keep pouring until all the solution has been flushed through the dispenser.
8. **Wipe down the inside of reservoir with a clean paper towel.**
9. **Disconnect the 1/4 inch tube from the ventilation port.**
10. **Return the magnetic stir bar to the bottom of the reservoir.**



BROOD recommends the following cleaning detergent: 1-2-COLD BREW Cleaner by Urnex

QUICK SOLUTIONS

| | | |
|--|---|--|
| There is too much nitro | The calibration knob is not set correctly. | Follow steps in to decrease the level of infusion outlined in section “Nitrogen Calibration” |
| There is no nitro even though it's set to maximum. | There is a block in the spout | Unscrew the spout and check to see if there is any sediment. Remove the components inside the spout and wash thoroughly. |
| Too many large bubbles | BiB bladder is not facing downward. | Place the outlet of the bladder at the bottom of the reservoir. The pump will only pull liquid. It will prevent it from sucking in air that is in the bladder |
| Product is not cold enough. | The temperature setting is too high. | Check to see if the main switch underneath the machine is on. Follow the instructions in the manual to change the temperature setting. |
| | The cold brew in the container hasn't chilled yet. | After pouring room temperature liquid inside the reservoir, it will take approximately 25 minutes to reach 2°C. |
| DRNX BRW is not pouring cold brew. | The pre-filter is clogged. | Unscrew the left panel, and located the pre-filter. Unscrew the cap and remove the internal mesh. Clean and return the mesh. Screw the cap back on. |
| | There is no electrical power connected to the machine | Check to see if the main switch underneath DRNX BRW is on. Then check to see if the pump switch on the top of the machine is on. If either one is off, please switch them on. If the pump switch is flashing, switch it off then on to reset the pump. |
| | The pump ON/OFF switch needs to be reset. | When your container is empty, the pump turns off and the ON/OFF switch flashes red. Switch it off then on to reset the pump. |

Q. I JUST RECEIVED MY DRNX BRW, HOW DO I SET IT UP?

A. Please follow the instruction manual that comes with DRNX BRW. It is easy to set up!

Q. WHERE DO I PUT MY COLD BREW COFFEE OR TEA?

A. DRNX BRW has an internal chilled reservoir. Either pour your cold brew or tea directly into the reservoir or connect your BiB bladder to the bottom of the reservoir. Please watch our instructional video on our website drinkbrood.com.

Q. I AM NOT GETTING ENOUGH CREMA, WHAT SHOULD I DO?

A. Firstly, pull the tap downward fully (90°) to trigger nitrogen infusion. Pulling it only a little bit will yield still cold brew only. Secondly, rotate the infusion dial towards the 12 o'clock position. Thirdly, the pre-filter might be clogged and in need of cleaning. Check our troubleshooting section.

Q. I AM GETTING LARGE BUBBLES IN MY NITRO COLD BREW, WHAT SHOULD I DO?

A. If you are using a BiB bladder, make sure the outlet sits at the bottom of the reservoir. This will prevent the pump pulling in any air that would settle at the top of the bladder, if any. The quality of the cold brew also has a marked effect on the size of the bubbles in the final head of the drink. The more filtered the cold brew, the smoother the surface of the head. Make sure to filter to a fineness of min 100µm.

Q. MY BEVERAGE IS NOT COLD ENOUGH, HOW DO I MAKE IT COLDER?

A. Follow the instructions in section "Temperature Control" on page 6 or visit drinkbrood.com/brood/FAQ to decrease the temperature.

Q. DRNX BRW IS NOT POURING COLD BREW, WHAT SHOULD I DO?

A. There are several reasons why this may happen. All of them are easily remedied. Please follow our troubleshooting guide in this instruction manual or visit drinkbrood.com/brood/FAQ.

Q. DRNX BRW HAS A SOUND THAT COMES AND GOES, WHY?

A. This is the sound of the exhaust fan. When this sound is heard it means that the fridge is cooling down to the pre-set temperature. When the sound stops this means that the compressor has also stopped as the desired temperature has been reached.

Q. DO I NEED TO KEEP A GAP AROUND THE VENTS ON THE TOP OF DRNX BRW?

A. Yes, never cover the exhaust located at the back of the machine. Allow for at least 20cm of clearance. If covered, it may damage the compressor.



The warranty period is 1 year. Please review our warranty terms and conditions.

In order for the products to be stable, long lasting, AND covered under this manufacturer's warranty, these requirements must be met:

DRNX BRW is designed to be installed in interior areas with relative humidity levels of 35%-60% and operate at temperatures between (13°C - 32°C). DRNX BRW must be stored at temperature between (13°C - 40°C). Prior to opening original packaging or installation material, ensure that the spaces are enclosed and completely weatherproof, and the building temperature and humidity conditions are consistently maintained at the indicated levels. The product **MUST** be stored in an environmentally controlled space at all times. Do not store the product in direct sunlight.

THIS WARRANTY DOES NOT COVER:

- Any machine NOT distributed by BROOD Refreshments Company Ltd.
- Any machine NOT purchased from an Authorized BROOD Dealer (email us at hello@drinkbrood.com to check for authorized dealers or check our website at www.drinkbrood.com).
- Damage caused by accident, abuse, negligence, or misuse.
- Improper operation or failure to follow instructions contained in the manual.
- Any service or alteration performed by an unauthorized person, company, or association.
- Damage caused by neglecting to clean and/or maintain upkeep of DRNX BRW.
- Damage caused by use of undissolved instant coffee or any other ingredients not allowed in the dispenser.

This warranty is not transferable and applies to the original purchaser only.

The warranty period begins on the delivery date. If our transportation, storage or installation instructions are not followed, any warranty shall lapse. The warranty period is 1 year. The purchaser must inform BROOD Refreshments Company Ltd in writing of any transportation damages without delay, but at the latest within one week of arrival of the equipment. The purchaser must cease any processing or handling of the damaged units. BROOD does not accept any guarantee against defects which are due to improper storage or use of the products. The storage and use of the products presuppose that full knowledge and experience of the technology is taken into account to avoid detrimental effects on the quality and stability. This warranty does not cover damage caused by improper maintenance or by use contrary to our recommendations. There are no implied warranties, representations or conditions, except those required by statute, and they shall not extend beyond the term of the warranty applicable to your purchase.

CLEANING IS A CRITICAL PART OF MAINTAINING THE LONGEVITY OF DRNX BRW

- Prior to installation, use a clean soft cloth that has been dampened to remove dust or other foreign materials from panel surfaces. Dirt and grit should not be allowed to build up as these may scratch the finish during setup.
- Do not apply soap or cleaner directly to panel surfaces. Apply water to cloth and then wipe panel surfaces.
- Do not apply any solvents to panel surfaces, even by transfer from a cleaning cloth.
- Damage from solvents may not be immediately noticeable upon application. Do not use brushes to clean panels or vents as bristles will scratch panel surfaces.
- Daily flushing of DRNX BRW as outlined in the operation manual is required.
- Cleaning DRNX BRW consistently is crucial to the operation and lifespan. Any negligence in daily cleaning and upkeep of DRNX BRW will risk damaging the machine over time. The warranty period is 1 year. Please review our warranty terms and conditions. To make a warranty claim, please email hello@drinkbrood.com. For faster service, locate the model type and serial number, and include them in your email.



To make a warranty claim, please email hello@drinkbrood.com. For faster service, locate the model type and serial number, and include them in your email.

STORAGE

Before placing DRNX BRW out of service for a period longer than 2 weeks, we recommend the weekly cleanse as per the instructions in the Care section. Store DRNX BRW in a dust-free environment between 13°C and 40°C.

DISPOSAL

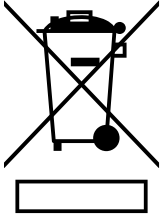

The packing materials can be recycled. Unplug the appliance and the power cord. Deliver the appliance and power cord to a service centre or public waste disposal facility. This product may not be treated as household waste. Instead it shall be handed over to the applicable collection point for the recycling of electrical and electronic equipment. By ensuring this product is disposed of correctly, you will help prevent potential negative consequences for the environment and human health, which could otherwise be caused by inappropriate waste handling of this product. For more detailed information about recycling of this product, please contact your local city office, your household waste disposal service or the shop where you purchased the product.

