

INSTRUCTIONS

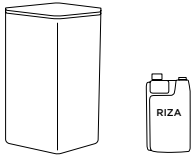

1 STEP DILUTION PROCESS RINZA

CONTAINER SIZE	CLEANER/SANITIZER	WATER
3Liter	180 mL	3Liter

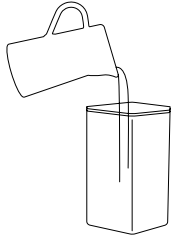

1. Fill the container with 1.5L of clean water



5. Rinse the container with clean warm water

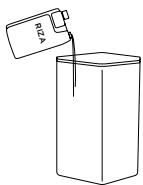

2. Add 180 mL Rinza Solution to the container and fill with an additional 2.5L of clean water. Measure carefully.

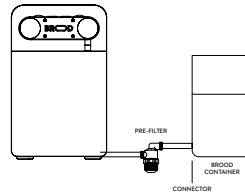

6. Fill the container with clean water, then run 3L of fresh water through the tap before re-attaching your cold brew BiB.

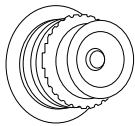

3. Detach the QCD Adaptor from the Bag in Box (BiB) and replace it with a “pink cap.” Then, place the assembly into the container. The “pink cap” serves to open the valve within the QCD Adaptor, allowing the flow of Rinza Solution through the beverage tube.

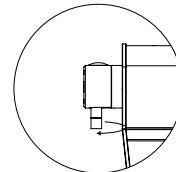

7. Unscrew the tip of the spout, and rinse.

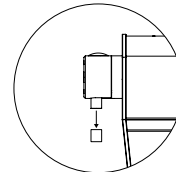

4. Place an empty container under the tap spout. Run the solution through the system for 40 seconds and let stand for 15 minutes. Remove the ventilation tube from the container. Then run the remaining solution through the system.

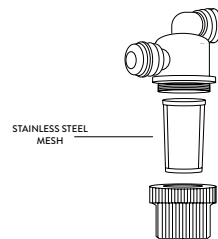
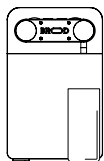

8. Unscrew the cover of the pre-filter by turning it counter-clockwise. Remove the stainless steel mesh and wash with clean hot water. Make sure the stainless steel mesh is not clogged.

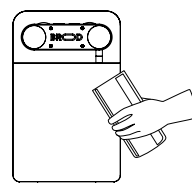

9. **BEFORE SERVING:** Place a glass under the tap. Pull the tap down until the water is flushed out and cold brew begins to flow freely, then close the tap.