

SETUP

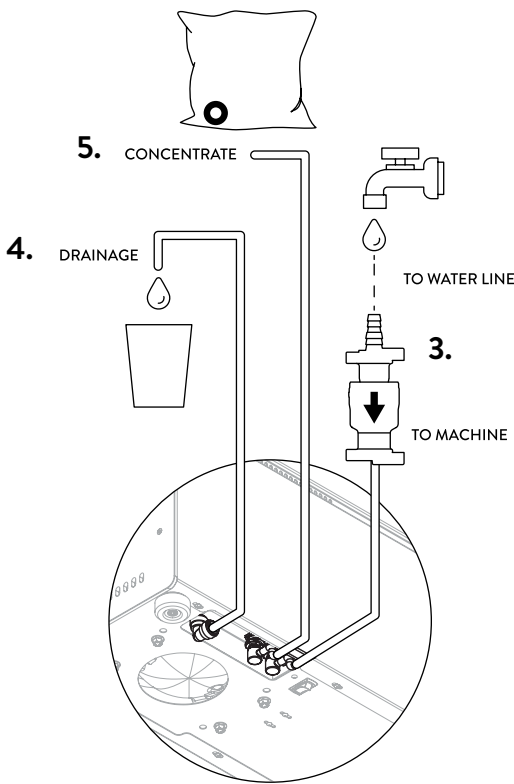

1. **Install on clean dry surface.**
 - Allow no less than 5 centimetres of space from all sides.
2. **Plug the power cord into an electrical outlet.**
3. **Attach a water line to the pressure reducer's inlet, located at the exposed ¼" barb on the tail end of the reducer.**
 - Ensure the tube is securely tightened and fastened with a crimp.
 - Turn on the water supply.
4. **Connect the drain tube to an empty container with a capacity at least equal to that of the Bag-in-Box (BiB) Concentrate.**
 - This serves as a safety measure in case of overflow.
5. **Connect the Beverage Tube to DRNX MIX by pushing the elbow fitting into the connection underneath the machine.**
 - Tilt the machine slightly if you need to. If you need to release the beverage tube, push the metal spring next to the connection underneath.
6. **Connect the Beverage Tube to the BiB. Follow the provided instructions below if using a Scholle Quick Connect Adapter.**

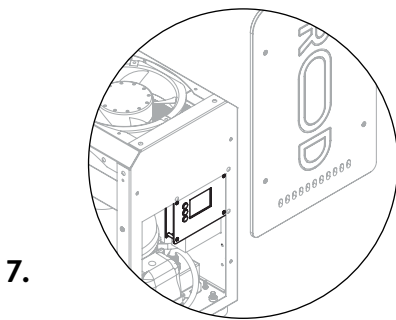

7. **Remove the back panel to access the Ratio Controller using a standard Philips drive.**
8. **Screen Unlocking:**
 - To unlock the screen, press the center button three times consecutively, followed by a single press of the bottom button. Note that the screen will automatically re-lock after 30 seconds.
9. **Dialling in Ratio Pump:**
 - Adjust the Ratio Pump settings to match your desired preference, keeping in mind that the highest achievable setting is 130.

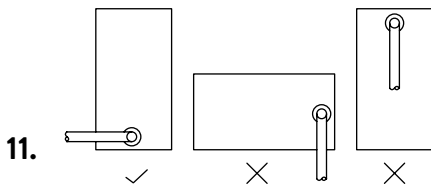

10. **Understanding Ratio Settings:**
 - For reference, a setting of 005 indicates less dilution, resembling a 1:1 ratio. As you progress towards 130, more water dilution occurs, resulting in less concentrate being pumped. Changes in ratio will only be noticeable after pouring approximately 500mL into a cup.

11. **BiB Concentrate Placement:**
 - When using concentrate in a BiB, it's crucial to position the BiB outlet downward, not upwards. This arrangement ensures an uninterrupted flow of concentrate and eliminates potential air pockets within the BiB.

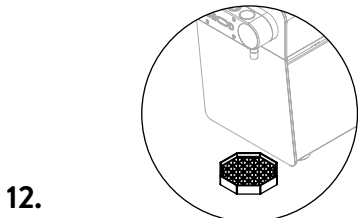

12. **Place Drip Tray beneath the spout.**